

# LAUNCH

# USER'S MANUAL

---

PFP-150



**LAUNCH TECH CO.,LTD.**

[www.cnlaunch.com](http://www.cnlaunch.com)

---

**NOTE:**

- Carefully read the user manual before using, and keep it well for future reference.
- Carefully check the device parts list before using. For any doubt, contact Launch distributor immediately.
- Due to the product upgrade, tiny difference between the user manual and the device will not be further noticed. Take the device as standard.

Copyright reserved! Without written agreement from Launch Tech Co., Ltd (Hereinafter refer to "Launch"), any company or person is not allowed to copy and duplicate this user manual in any format (electronic, mechanical, video, record or other formats). The user manual is designed only for Launch products. Any consequence caused by using the user manual to guide other device operation is not under the responsibility of Launch.

Launch and its branches are not responsible for the fees and expense of the device damage and loss due to private accident or from third party, misuse and abuse of the device, unauthorized change and repair, or any operation and maintenance not following Launch standard.

Launch is not responsible for device damage or problem due to the usage of any optional parts or consumables instead of Launch original products or Launch recognized products.

Declaration: Other product names mentioned in the user manual are aimed to describe the device usage. The registered trademarks still belong to the original company.

The device is for professional technicians or maintenance and repair personnel.

---

**Registered Trademark**

Launch has registered its trademark in China and several other countries, logo is **LAUNCH**. Other Launch trademarks, service marks, dot names, Icons, company names mentioned in the user manual all belong to Launch and its subsidiaries. In those countries where Launch trademark, service mark, dot name, icon, company name not registered yet, Launch declaim the right for its unregistered trademark, service mark, dot name, icon, and company name. Trademarks of the other products and company names mentioned in the user manual still belong to original registered company. Without written agreement from the owner, no person is allowed to use the trademark, service mark, dot name, icon and company name of Launch or of other mentioned companies. You can visit <http://www.cnlaunch.com> or write to Customer Service Center of LAUNCH TECH CO., LTD at Launch Industrial Park, North of Wuhe Avenue, Banxuegang, Longgang District, Shenzhen, P.R.China, to get contact with Launch for the written agreement on the usage of the User Manual.

# INSTRUCTION

## **Note:**

This manual contains safety and operating instructions. Read it carefully before using or servicing the device. Do not neglect to do this as improper handling may result in personal injury and damage to the device.

The safety precautions are printed on the top panel of the device. Make sure the device is to be used under right circumstances and conditions. Otherwise, it may damage the charger or devices connected to the charger, and injury to persons.

Charging produces flammable gases. During the charge, the battery must be placed in a well ventilated area. Avoid flames and sparks.

To maintain the factory original performance of your device, use only manufacturer's suggested replacement parts. Model and serial number required when ordering parts from your local distributor.

Do not use the charge if it has been dropped or damaged. Make sure the exterior appearance is in good condition without any obvious damages, to avoid short circuit and other problems caused by damage to the internal components.

The charger is designed for charging rechargeable batteries only. Do not use to charge disposable batteries or non rechargeable batteries, otherwise it may cause the battery and charger damage or even explosion. In case of the battery acid contact with the eyes or skin, rinse well with water and see a doctor as soon as possible.

## **Caution:**

Risk for electrical shock ! All electrical connections must be made by a qualified electrician. Make sure that the facility supply voltage and frequency are the same as shown on the charger name plate. Make sure the supply cable also meets the specifications of the charger unit.

Make sure the red clamp to the (+) and black clamp to the (-) of the battery.

Keep the charger clean.

Frequently inspect all power cables for damage or bare wiring. Replace cable immediately if damaged.

Turn off the charger and disconnect the charger from the mains when not in use.

Disconnect input power supply before installing, checking, cleaning or changing parts.

Only qualified persons should install, operate, maintain and repair this charger. Consult the manufacturer or supplier before servicing.

Keep charger as far away from children as practical. Properly install and ground this equipment.

Electric shock can kill.

To prevent dangers and accidents, a person to keep an eye on the device and battery during the whole charging process is strictly required. Do not place or operate the charger near water, in wet locations or outdoors.

## **Note:**

1. Fully use the length of charging cables to keep the charger away from the battery when connecting the charger to the battery.

2. Never place the charger on top of a battery.

3. Keep well-ventilated and dry condition.

4. Make sure the power supply and charging clamps is properly connected.

5. Press Start/Stop button and disconnect the clamps to stop the charger during charging process. Do not disconnect the power by simply unplugging the charger.

After charging, disconnect the charger from the mains, then disconnect the clamps from the car body and then disconnect the clamp from the battery, in the indicated order.

6. It will take a longer time for the battery to be fully charged as there will be a relatively longer time for floating charge.
7. Never attempt to charge a damaged or short-circuited battery.
8. Battery should not be charged unattended .

### ***Work Mode Instruction:***

Before turning on the charger, make sure that the supply voltage, power plug size meet the requirements of the specification of the charger, and batteries are in good condition. Work mode must be selected and operated correctly.

- 1)**Charging mode:** For charging the battery under normal conditions. If the battery has been left idle for a long time or has suffered a discharge deeply, it may be necessary to forced start and recovery. It is necessary to make different selections as to whether the battery is inside or outside the vehicle and the machine will process the selection differently. The next step is to select the type of battery in order to carry out different charging voltages and currents. A proper and correct selection will allow the charger to better charge the battery and protect it.
- 2) **Programming mode:** It provides a stable voltage to the vehicle electrical system to support the reprogramming/reflashing of the ECU. The battery needs to be charged to full capacity level first to avoid voltage instability due to charging. The reprogramming/reflashing voltage can be adjusted as required. Please operate correctly and adjust to the appropriate voltage. A stable voltage source will enable the ECU system to be successfully reprogrammed and reflashed.
- 3)**Showroom mode:** Long-term parked showroom vehicles can easily become unusable due to low battery power, resulting in serious battery loss and damage.This showroom mode will continually charge the battery as needed, with a small current to ensure that the battery is always fully charged and protected.
- 4).**Repair mode** : This mode will be based on the charger to make a judgment on the status of the battery, and then prompt whether to repair.If you need to repair please manually select repair, and follow the instructions to repair.

### ***Battery Alarm Instruction:***

- 1) **Clamps' poor contact alarm:** If the alarm persists when the battery voltage is above 5V with normal connections, remove the clips from the battery and reconnect it after cleaning the battery electrodes.If this does not work, press and hold the OK button and follow the instructions to enter the repair mode. In case of prolonged absence of current, please contact the after-sales service.
- 2) **Overheat Alarm.** Take off charging clamps, keep the charging on and wait for a while for the inner fan cooling. Alarm stops and interface is back to normal page when temperature decreases. Do not use the charger and contact after-sales if there is overheat alarm at the moment of charger turning on.
- 3) **Over current Alarm.** It is likely because of batteries' low power or sudden loading increase during charge. Adjust the power into 12V on programming mode for low power. Shift to normal charge as current less than 8A.
- 4) **Reverse Polarity Alarm.** Ensure normal connection of charging clamps.
- 5) **Damaged Battery Alarm.** Replace batteries.
- 6) **Full Charge Alarm.** It is a prompt for charge finishing. If charging period is short, and battery voltage decreases rapidly for cars, the battery is broken and should be replaced.

**OPERATION PANEL IS AS FOLLOWS:**

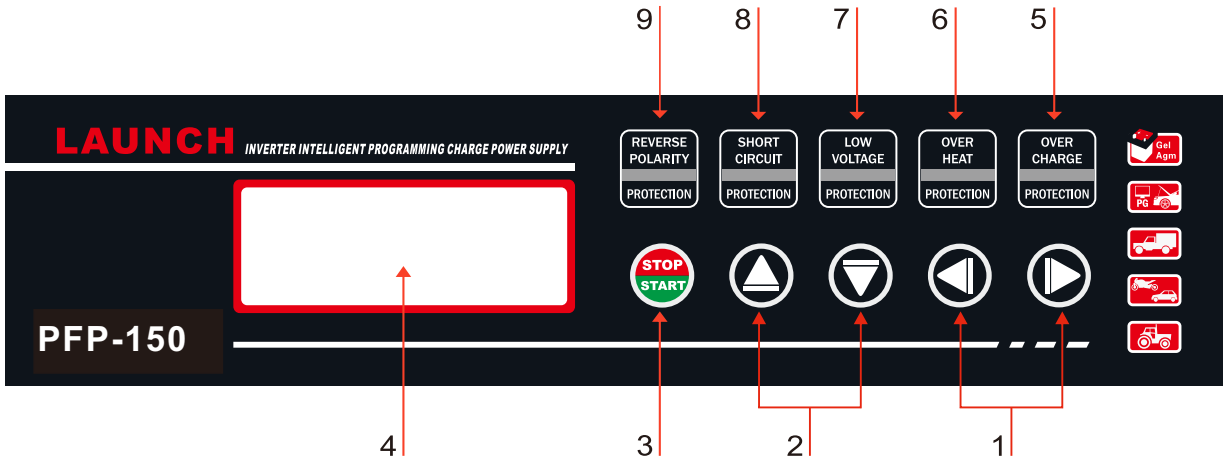

1. Right / Left

2. Up / Down

3. Switch

4. Monitor

5. Overcharge Protection

6. Overheat Protection

7. Low Voltage Protection

8. Short Circuit Protection

9. Revert Polarity Protection

Chinese and English switching:

**STOPKEY+RIGHTKEY+LEFTKEY**

**OVERCHARGE PROTECTION:**

the machine will constantly detect the battery state to prevent damage from overcharging in the charging process.

**OVERHEAT PROTECTION:**

It will automatically stop charging when the machine is overheated. The internal fan starts to works.

**LOW VOLTAGE PROTECTION:**

When the input voltage is lower than required, the machine will not work.

**SHORT CIRCUIT PROTECTION:**

The machine will not work and alarm when internal part short circuit.

**REVERT POLARITY PROTECTION:**

The LCD displays if the battery clip is reversed.

**ON/OFF:**

If the charging clamp is in bad contact, press the key to enter the forced start mode.

Press left and right keys to switch options, up and down keys to the previous step and the next step. Press the start stop button to start or stop the machine.

You need to select the adjustable mode to adjust the programming voltage, then press right and down buttons at the same time, after hearing the warning tone, you can use the up and down keys to set voltage. After setting, press the right and down keys again to logout, then press ON to start.

## OPERATION PROCEDURE:

The machine will automatically adjust the charging voltage and current during charging process.

### Charging Mode

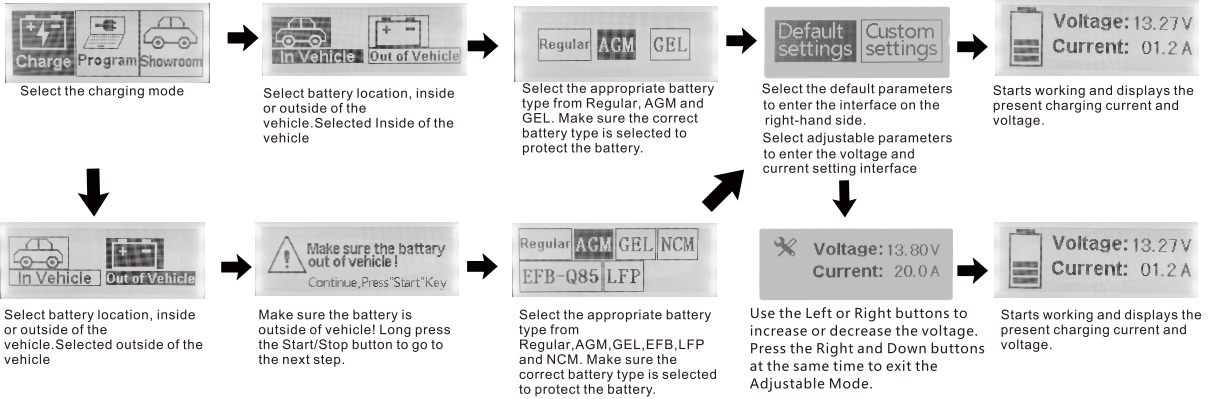

### Programming Mode

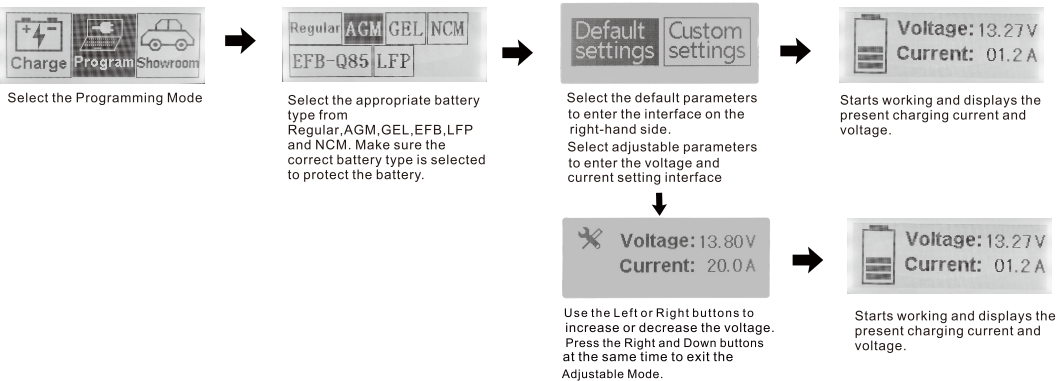

### Showroom Mode

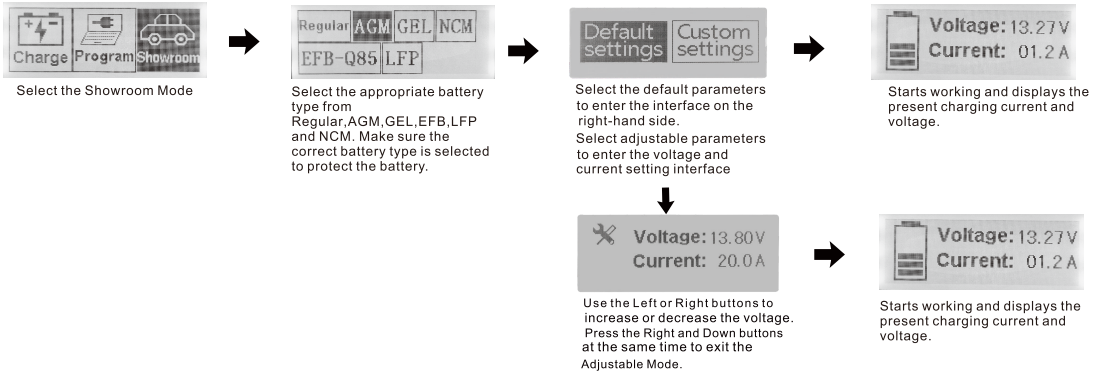

## OPERATION PROCEDURE:

The machine will automatically adjust the charging voltage and current during charging process.

### Repair Mode

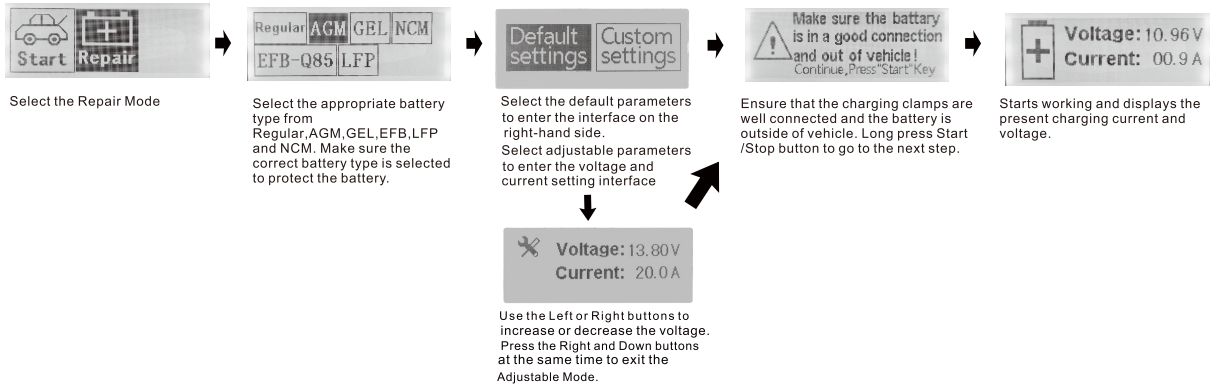

### Starting Mode

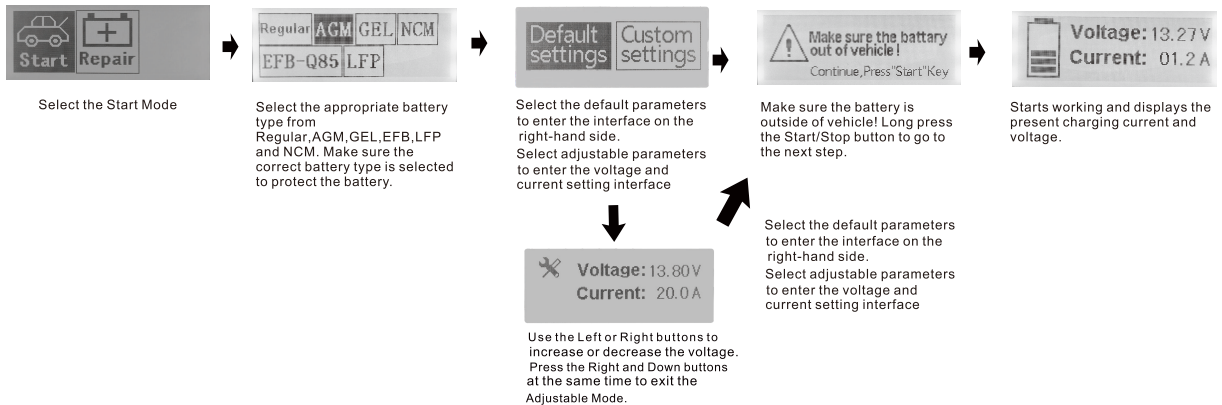

### IMPORTANT!

- 1.The power supply to the charger must be equipped with leakage circuit breaker.
- 2.Follow the instructions in the user manual to operate the charger.
- 3.The charger must be regularly serviced and maintained by professionals.
- 4.Select the battery type from ,Regular,AGM,GEL,LFP and NCM correctly to protect both the battery and the vehicle.
- 5.EFB,LFP and NCM batteries must be separated from the vehicle during charging! Otherwise there is a risk of damage to the vehicle.
- 6.The battery must be separated from the vehicle during battery repair process! Otherwise there is a risk of damage to the vehicle.
- 7.This charger is not a complete battery replacement. When replacing the battery, a backup battery must be connected.

---

## SPECIFICATION DATA

Item	Unit	Item	Unit
Input Voltage	110V	Programming mode	12-14.8V/2-150A
Rate	50-60Hz	MAH	10-1800Ah
Input Power	1800W	Demension	44x41x14CM
MAX	150A RMS	Weight	9KG
Charging Voltage	12V		

---

**Batteries must not be charged unattended to avoid any dangers.**

**Follow the installation and operation instruction to ensure user safety and proper equipment performance. It is the responsibility of the owner to ensure that the equipment has been installed and operated as specified in the instructions provided. The manufacturer takes no responsibility for any loss or damage suffered as a result of using the equipment incorrectly or improperly.**

## ***Warranty Clause***

The warranty clause is only applicable to users and distributors who purchased Launch products via the regular process.

Within 1 year since the delivery, Launch guarantee the products damaged due to the material or craft defects. Any damage to the device or part due to abuse, unauthorized change, usage other than designed to, operation not following the user manual, etc. is out of the warranty compensation for the auto instrument damage due to the device defect is limited to repair or replacement, Launch is not responsible for any indirect or accidental loss. Launch will clarify the device damage according to the specified test method. Any distributor, employee and business representative of Launch are not entitled to do any confirmation, presentation or promise related to Launch products.

## ***Statement of Disclaimer***

The above warranty clause can substitute for any other form of warranty clauses.

## ***Purchase Order***

Replaceable parts and optional parts are available from Launch authorized suppliers. Purchase order should include:

- Order quantity
- Part number
- Part name

## ***Customer Service Center***

Any question during the operation, please call +86-755-84528888

For maintenance and repair, please send back to Launch with Warranty Card, Product Qualified Card, Purchase Invoice and problem description. Launch will maintain and repair the device for free when it is within the warranty. Otherwise, Launch will charge the maintenance and repair and the shipping.

## ***LAUNCH address:***

# **LAUNCH TECH CO.,LTD.**

No.4012, Launch Industrial Park,

North Wuhe Rd, Bantian Street, Longgang District, Shenzhen, China

<https://www.cnlaunch.com>

Zip Code: 518129